



Estate  
homesites  
offered from  
\$650,000

## PARADISE BEACH

Beautiful 2/3-acre building lot along Paradise Beach with 120-feet of frontage along pristine white sand. Calm waters lap up to the beach which stretches from Charlestown north to Cades Bay. Views of St. Kitts from Basseterre to the Southeast Peninsula are exquisite. Property is 360-feet deep and filled with palms and other varieties of tropical plantings. Land is perfectly located just north of the Four Seasons Resort Nevis' restaurant called Mango and is surrounded to the north by the undeveloped lands of Paradise Estate. The perfect location to build a beachfront getaway or other beachfront enterprise. Offered at \$650,000.



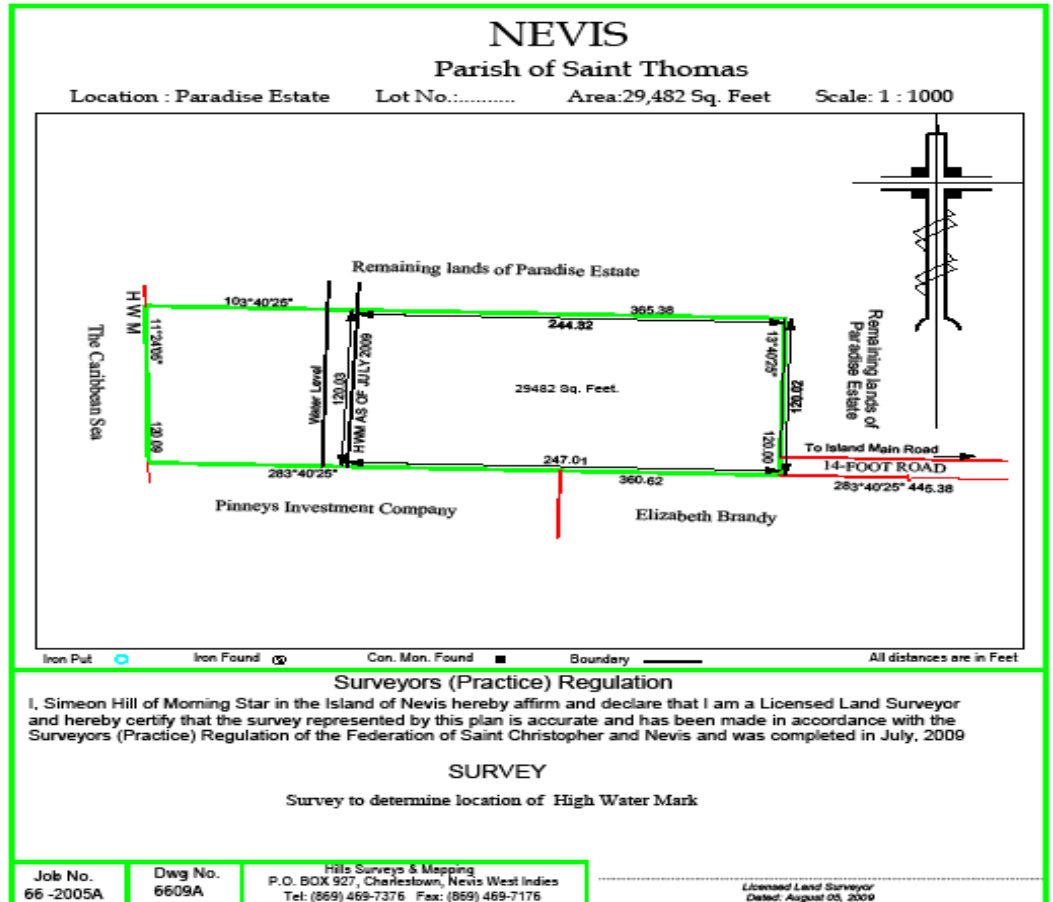

*The above information is believed to have been gathered from reliable sources, but is based upon information gathered from third parties, therefore may not be complete or totally accurate.*

Copyright 2008 Nevis Houses, Sugar Mill Real Estate, All Rights Reserved A GideonCardozo Site

**For more information:**

**Sugar Mill Real Estate**  
**Located at SEASIDE at Cliffdwellers**  
**Nevis, West Indies**  
**Phone: 869.469.1093 (Office)**  
**869.663.8910 (Cell)**  
**917.522.1843 (NY in Nevis)**  
[\*\*info@nevishouses.com\*\*](mailto:info@nevishouses.com)